

# Venue Cymru - Cultural Hub

## First Floor Plan

March 2025 1:200 @ A3

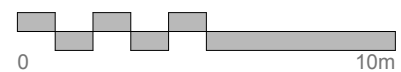

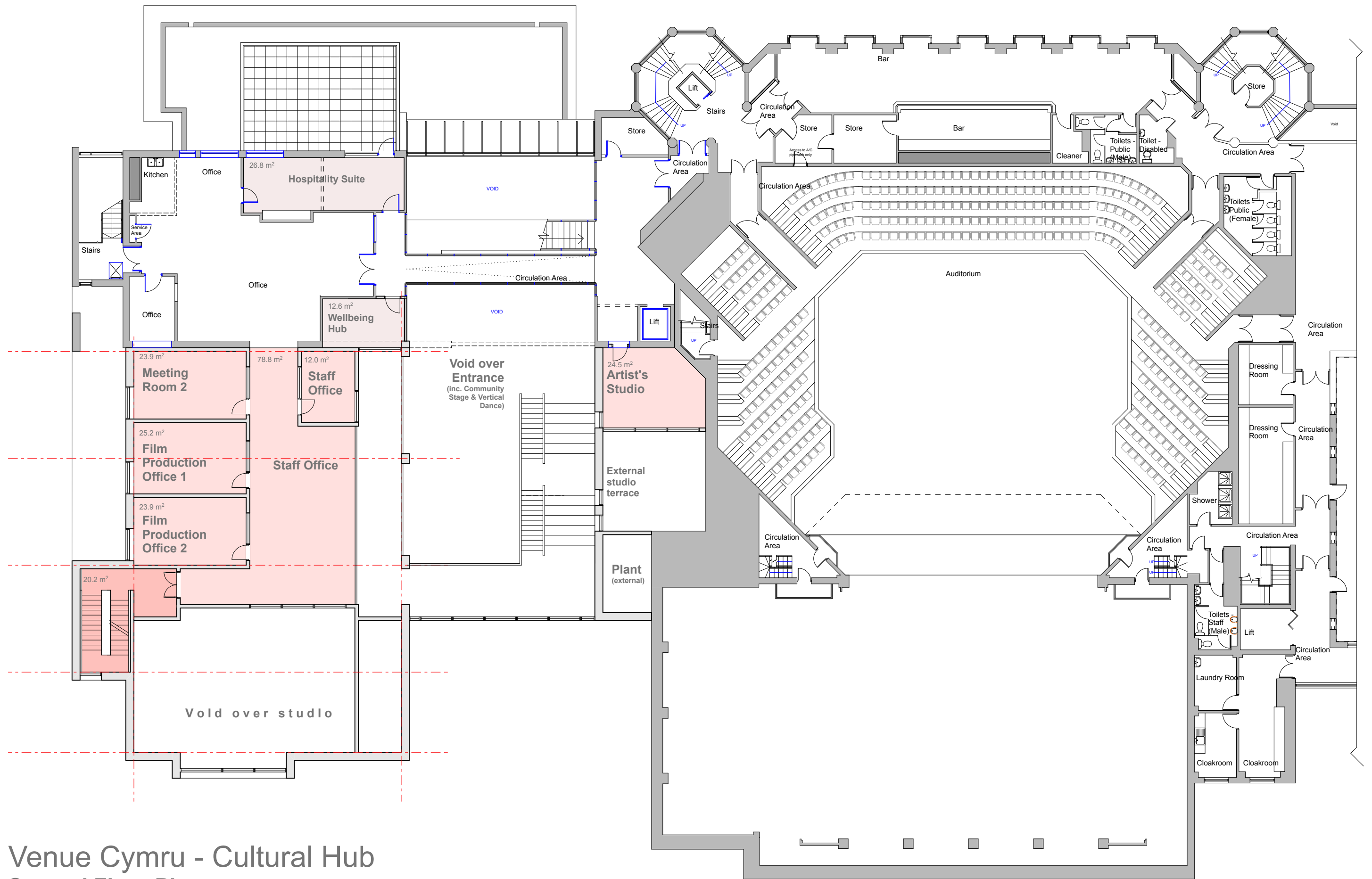

# Venue Cymru - Cultural Hub

## Second Floor Plan

March 2025 1:200 @ A3

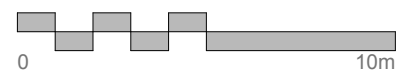

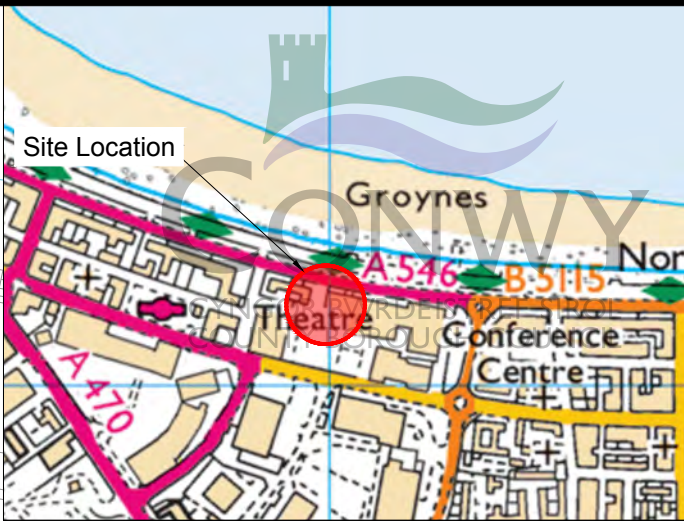
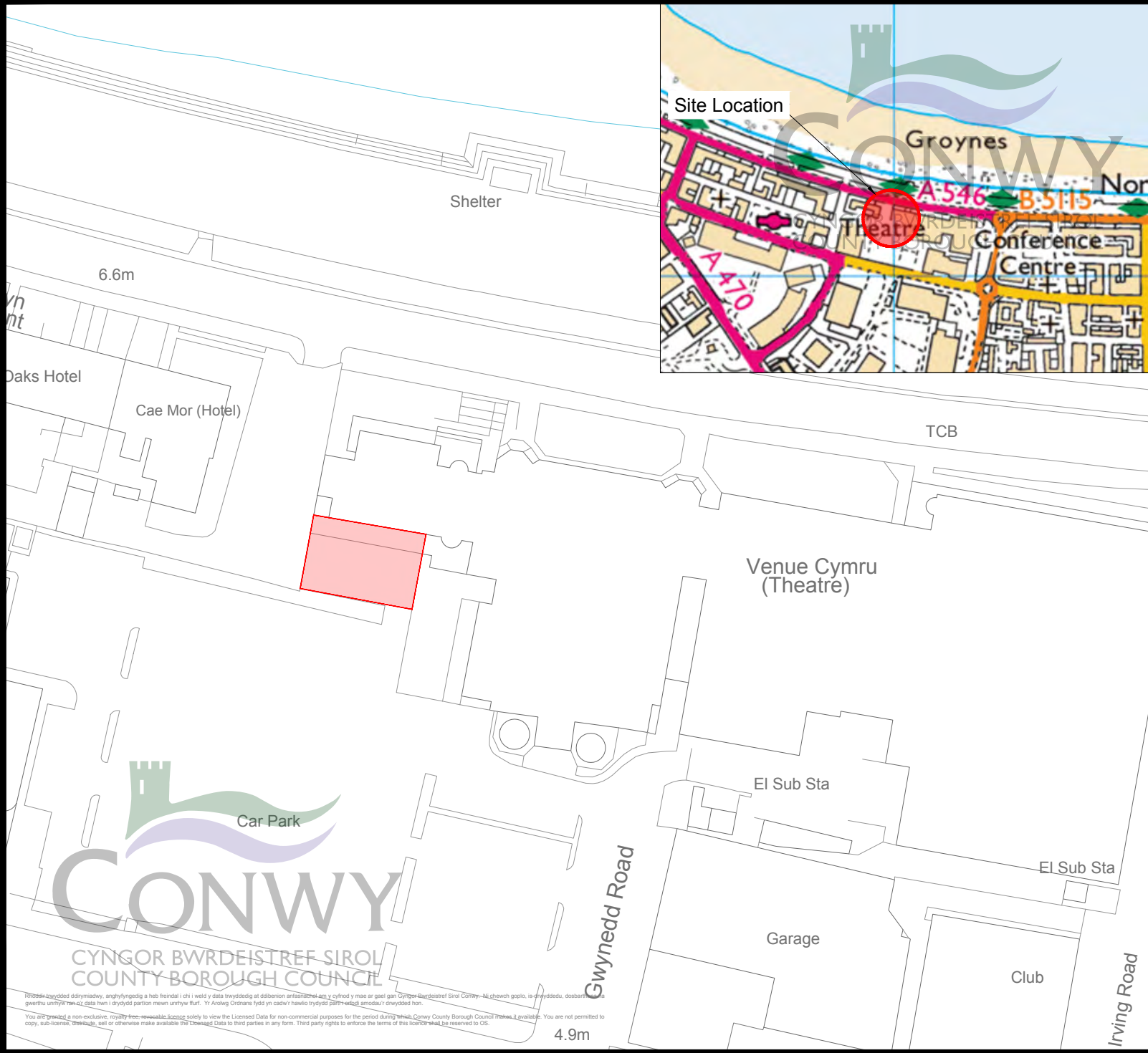

Hawffrwynt y Goron a hawliau cronfa ddata  
2024 Arolwg Ordnans 100023380  
Crown copyright and database rights 2024  
OS 100023380

KEY/NOTES



Site Extents



Site Address:  
Venue Cymru  
LL30 1BB  
Easting: 279005  
Northing: 382095

| REV | DETAIL | DRAWN | CHECKED | DATE |
|-----|--------|-------|---------|------|
|     |        |       |         |      |
|     |        |       |         |      |

PROJECT

Venue Cymru  
Futures Project

TITLE

Location Plan

CLIENT

Economy and  
Culture

| SCALE @ A4: | DRAWN:<br>JAC<br>DATE:<br>29 05 2025 | CHECKED:<br>MB<br>DATE:<br>29 05 2025 | APPROVED:<br>MB<br>DATE:<br>29 05 2025 | DWG STATUS:<br>Draft |
|-------------|--------------------------------------|---------------------------------------|--|----------------------|
|-------------|--------------------------------------|---------------------------------------|--|----------------------|



ENVIRONMENT,  
ROADS & FACILITIES

G.B. Edwards BEng (Hons) CEng FICE  
Head of Environment, Roads & Facilities,  
PO. Box 1, Conwy, LL30 9GN

01492 575337  
[affch@conwy.gov.uk](mailto:affch@conwy.gov.uk) / [erf@conwy.gov.uk](mailto:erf@conwy.gov.uk)

|                           |   |                    |          |
|---------------------------|---|--------------------|----------|
| PROJECT Ref:<br>ECEC2502N | / | DRAWING No:<br>101 | REV<br>A |
|---------------------------|---|--------------------|----------|

Rhwybuddio ddiwydiol, anghyfyngedig a heb frendal i chi i weld y data twyddedig at ddisennu arfaethu a chynhyrchu y mae ar gael gan Gyngor Bwrdeistref Sirol Conwy. Ni cheir gwpio, is-nyddio, dosbarthu neu gwerthu unrhyw ddata hwn i drydydd parti neu unrhyw ffur. Yr Arolwg Ordnans fydd yn cadw'r hawlio trydydd parti heddiw amodol a'i ddiwydded hon.  
You are granted a non-exclusive, royalty-free, non-transferable licence solely to view the Licensed Data for non-commercial purposes for the period during which Conwy County Borough Council makes it available. You are not permitted to copy, sub-license, re-sell, or otherwise make available the Licensed Data to third parties in any form. Third party rights to enforce the terms of this licence shall be reserved to OS.





SOUTH ELEVATION  
EXISTING



SOUTH ELEVATION  
PROPOSED





WEST ELEVATION

EXISTING



WEST ELEVATION

PROPOSED











